

CITY OF MONONA
DANE COUNTY, WISCONSIN
BELLE ISLE
2011 STREET AND UTILITY IMPROVEMENTS

- LEGEND
- ROW LINE (APPROXIMATE)
 - ST --- STORM SEWER PIPE
 - FIELD INLET
 - UTILITY POLE
 - EDGE OF CONCRETE DRIVEWAY
 - EDGE OF ASPHALT DRIVEWAY
 - EDGE OF PAVEMENT
 - TREE
 - GUARD RAIL
 - RETAINING WALL
 - PROPOSED STORM SEWER
 - BACK PITCH DRIVEWAY
 - FRONT PITCH DRIVEWAY
 - PROPOSED BACK PITCH DRIVEWAY CONVERTED TO FRONT PITCH
 - PROPOSED STORM SEWER FOR NEW LIFT STATION (2 ALTERNATIVE DISCHARGE LOCATIONS SHOWN)
 - PROPOSED STORM SEWER FOR JOYCE/WINNEQUAH ROAD RUNOFF
 - PROPOSED LIFT STATION
 - PROPOSED STORM SEWER MANHOLE
 - PROPOSED STORM INLET
 - FLOW DIRECTION
 - STANDARD CURB AND GUTTER (SEE PICTURE 1)
 - MOUNTABLE CURB AND GUTTER (SEE PICTURE 2)



PICTURE 1



PICTURE 2

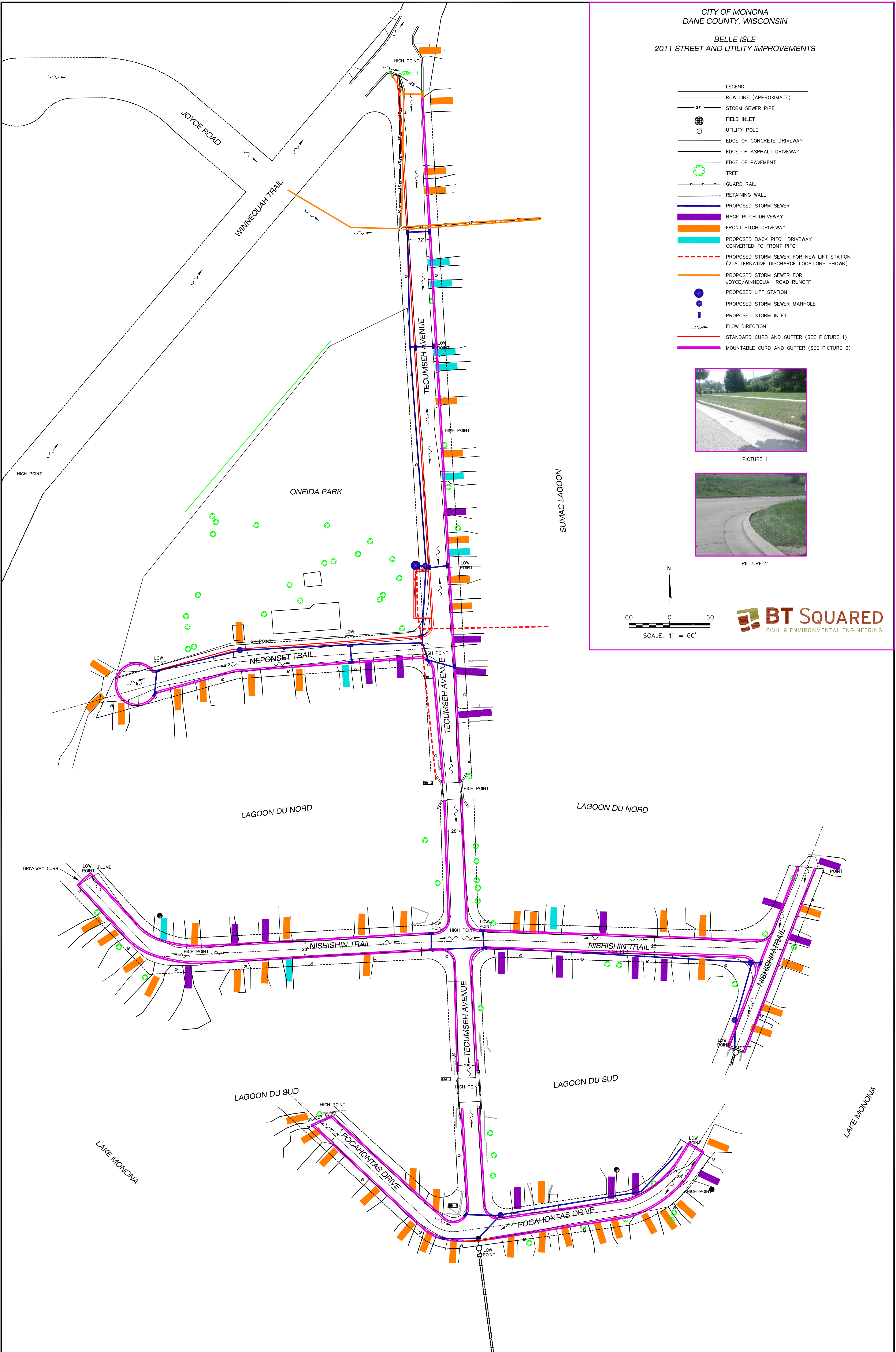
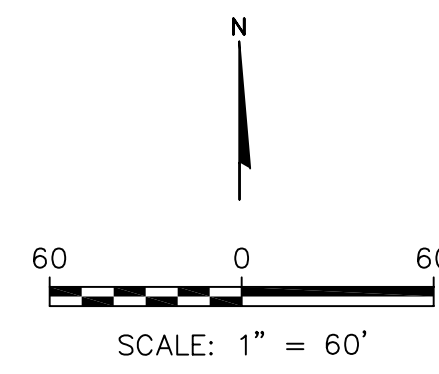

PROJECT NO. 4074	DRAWN BY: BS	ENGINEER: BT SQUARED	CITY OF MONONA	FIGURE 2
DRAWN: 06/16/2010	CHECKED BY: GB	2830 DAIRY DRIVE MADISON, WI 53718-6751 PHONE: (608) 224-2830 FAX: (608) 224-2839	5211 SCHLUTER ROAD MONONA, WI 53716-2598 608-222-2525	
REVISED: 06/30/2010	APPROVED BY: GB	CLIENT: []	SITE: BELLE ISLE STREETS CONCEPTUAL PLAN	PRELIMINARY DESIGN CONCEPTS DRAWING (WITHOUT AERIAL)

Belle Isle Streets Conceptual Plan, Drawing and Aerial, 06/30/2010 10:00 AM